

TEXAS  **EXES**[®]
— FLYING LONGHORNS —

Alaska's Inside Passage

Aboard *National Geographic Quest*

August 28 – September 4, 2027



Alaska's Inside Passage



Expedition Highlights

- ✓ Hike through lush forests and muskegs, kayak into secluded inlets, and cruise by Zodiac among electric blue icebergs and curious wildlife.
- ✓ Encounter iconic Alaska wildlife such as humpback whales, bears, otters, and bald eagles.
- ✓ Immerse yourself in the awe-inspiring grandeur of Glacier Bay National Park and Preserve or Glacier Bay's outer coast during a full day of exploration.
- ✓ Meet our conservation partners from the Alaska Whale Foundation (schedules permitting) and learn how you can contribute to their research throughout your voyage.
- ✓ Discover Alaska's seldom-seen, vibrant marine life revealed by our undersea specialist.
- ✓ With National Geographic Explorers-in-Training, our exclusive family program, kids and teens will learn about this wild corner of the world—from its massive glaciers to humpback whales.

Itinerary

DAY 1

JUNEAU, ALASKA/EMBARK

Arrive in Juneau, Alaska's capital—one of only two U.S. capital cities not accessible by car, it lies at the base of the picturesque Mt. Roberts. (D)

DAY 2

TRACY ARM-FORDS TERROR WILDERNESS

Explore the wild and remote areas of southeast Alaska by special use permit with the Tongass National Forest. Voyage into Tracy or Endicott Arm, both spectacular fjords with waterfalls cascading from glacially carved walls. See the soaring Dawes or South Sawyer Glacier up close and take a cruise in a Zodiac for an unbeatable view among sculpted icebergs. Keep an eye out for harbor seals, harbor porpoises and arctic terns. (B,L,D)

DAY 3

PETERSBURG

Visit the small, true Alaska fishing town of Petersburg on Mitkof Island, which still retains much of its Norwegian heritage. Explore a unique Southeast Alaska ecosystem, the muskeg, with stunted trees and carnivorous plants. There is an opportunity to stretch your legs with an optional bike ride around town. This evening, enjoy a crab feast. (B,L,D)

DAY 4

FREDERICK SOUND AND CHATHAM STRAIT

These waters are prime areas for both orca and humpback whales. With luck, guests may observe their fascinating behavior—breaching, tail-slapping and variations on feeding—as you listen to the play-by-play from your expert naturalists. Explore spectacular bays and inlets, following bear trails and salmon streams. Once ashore, you'll have the opportunity to walk along a quiet forest trail. The still waters are excellent for kayaking, offering another option for up-close exploration. (B,L,D)

DAY 5

ICY STRAIT AND THE INIAN ISLANDS

Explore among the Inian Islands, a busy feeding ground for myriad wildlife species, including Steller sea lions and sea otters. Search for marine mammals in the nutrient-rich waters of Icy Strait and choose the perfect spot around Chichagof Island to hike where sightings of bald eagles are common. (B,L,D)

DAY 6

GLACIER BAY NATIONAL PARK

Spend the entire day amid the coves, fjords, tidewater glaciers and majestic mountains of Glacier Bay National Park.* Witness glaciers that end abruptly at the water's edge and observe them calving, when tons of ice separate and crash into the water accompanied by a thunderous sound. Mountain goats scaling the peaks, as well as harbor seals, Steller sea lions and puffins, are some of the creatures you may observe. A visit to Tidal Inlet may bring the sight of brown bears lumbering up the hillside. (B,L,D)





DAY 7

SOUTHEAST ALASKA'S ISLANDS, BAYS AND FJORDS

Today, nature is your guide as you set forth with the flexibility to take advantage of wildlife and weather conditions. You might stop at an isolated beach to take a closer look at tide pools, beachcomb and hike stunning forest trails. Keep an eye out for old bear tracks worn into the soil as you move from forest to meadow. Sightings of bald eagles are common. If conditions permit, you'll have the opportunity to do some kayaking, always watching for marine and terrestrial life. (B,L,D)

DAY 8

SITKA/DISEMBARK

Disembark in Sitka and transfer to the airport for flights home. (B)

NOTE: This departure operates in reverse from Sitka to Juneau.

**The National Park Service Department of Interior authorizes Lindblad Expeditions as a Concessioner to provide Tour Vessel Services within Glacier Bay National Park & Preserve.*



National Geographic Quest

CAPACITY: 50 cabins accommodating 100 guests.

REGISTRY: United States. **OVERALL LENGTH:** 238 feet.

PUBLIC AREAS: Global gallery; fitness center; LEXspa; lounge with full service bar and facilities for films and presentations; observation deck; mudroom with lockers for expedition gear, and a partially covered sundeck with chairs and tables. The open Bridge provides guests an opportunity to meet the officers and captain and learn about navigation.

MEALS: Served in single seatings with unassigned tables for an informal atmosphere. Cuisine is fresh, sustainable, accented with regional flair and served plated.

CABINS: All cabins face outside with windows or portholes, private facilities and climate controls. Category 4 cabins have step-out balconies.

EXPEDITION EQUIPMENT: A fleet of 8 Zodiacs and 24 kayaks, stand-up paddleboards, ROV (remotely operated vehicle); hydrophone, splash-cam, underwater video camera and video microscope.

SPECIAL FEATURES: Guest Wi-Fi access, elevator, National Geographic -Lindblad Expeditions certified photo instructor, undersea specialist and a medical professional.

WELLNESS: The vessel is staffed by a wellness specialist and features a gym with an elliptical machine, treadmill, exercycles, handweights and resistance bands. Massages in the LEXspa are available by appointment.

LINDBLAD EXPEDITIONS—PIONEERING RESPONSIBLE EXPLORATION: From our consistent quest to improve our practices to offsetting 100% of our carbon emissions, supporting conservation, science and education initiatives around the planet and investing in the communities in the places we explore, we are guided by our commitment to explore responsibly.



National Geographic Quest

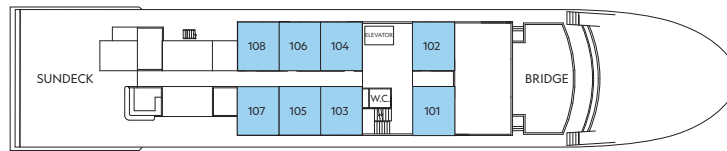

OBSERVATION DECK

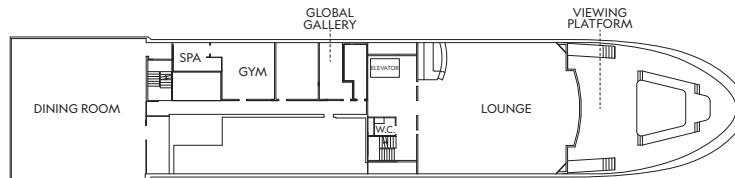

LOUNGE DECK



UPPER DECK



MAIN DECK

CATEGORY 1

Main Deck #301-306
Cabins feature two single beds that can convert to a queen, a writing desk and two portholes.

CATEGORY 2

Main Deck #307-315
Cabins feature two single beds that can convert to a queen, a writing desk and two portholes.

CATEGORY 3

Upper Deck #201-206
Cabins feature two single beds that can convert to a queen, a writing desk and two large view windows.

CATEGORY 4

Upper Deck #207-229
Cabins feature two single beds that can convert to a queen, a writing desk, sliding glass door and small, private balcony.

CATEGORY 5

Observation Deck #101-108
Cabins feature two single beds that can convert to a queen, large view windows, an expanded bathroom, writing desk, ample storage space and a convertible sofa bed to accommodate a third person.

NOTE: Solo Occupancy cabins are available in Categories 1 and 2 only. Third person rates are available in Category 5 cabins at one half the double occupancy rate.

Connecting Cabins via internal doorway access: Main Deck: #312-314, #311-315, #306-308, #305-307; Upper Deck: #224-226, #225-227

Alaska's Inside Passage

VOYAGE DATES	CAT. 1	CAT. 2	CAT. 3	CAT. 4	CAT. 5	CAT. 1 SOLO	CAT. 2 SOLO	ADVANCE PAYMENT
August 28 - September 4, 2027	\$7,815	\$8,362	\$8,944	\$10,731	\$11,808	\$15,630	\$16,724	15% of the cabin fare, per person

NOTE: The rates above reflect a special group savings of 5% off of the cabin fare. Valid on this departure date of *Alaska's Inside Passage*, for new bookings only, subject to availability, may not be combined with other offers, and is not applicable on airfare or extensions.

Terms and Conditions

PRICING: Prices quoted in this flyer are per person based on double occupancy in USD. Prices shown are subject to change and availability at time of booking. Under normal conditions the total expedition price is guaranteed at the time advanced payment is made. However, our expedition pricing is determined far in advance of initial departure on the basis of then-existing projections of fuel and other costs. In the event of increases in those costs, including but not limited to increases in the price of fuel, currency fluctuations, increases in government taxes or levies or increased security costs, we reserve the right to adjust the price of your expedition or add a surcharge to cover such unexpected increases. We will always provide an explanation of the reason for increase in costs.

COST INCLUDES: Accommodations aboard ship; all meals as indicated in the itinerary, beer, wine, cocktails and spirits with super premium wines and liquors available for purchase; all shore excursions, sightseeing, special access permits and entrance fees; transfers to/from airport if traveling within recommended arrival and departure windows; morning stretch classes and access to the fitness center; access to the OM System Photo Gear Locker; 24-hour access to the lounge, observation decks, library and other shared spaces; complimentary reusable water bottle; gratuities to local guides; basic Wi-Fi with the option to upgrade; services of Lindblad Expeditions' natural history staff, National Geographic certified photo instructor, medical professional and local guides; port taxes and service charges. Unused services or items included in this program are non-refundable.

NOT INCLUDED: Airfare; meals not indicated; extensions; passport, visa and immigration fees; travel protection plan; gratuities to the ship's crew; items of a personal nature such as certain super premium brands of wines and liquors, spa treatments, enhanced and premium Wi-Fi plans and laundry.

AIRFARE: Airfare is an additional cost. Lindblad Expeditions will gladly assist in making your air arrangements for a \$50 per person service fee.

RESERVATIONS: To confirm your place, an advance payment of 15% per person is payable by Visa, MasterCard, American Express, Discover or check. Receipt of advance payment indicates your acceptance of the terms and conditions.

FINAL PAYMENT: Due no later than 120 days prior to departure. Lindblad Expeditions reserves the right to cancel your reservation if payment has not been received by final payment due date.

TRAVEL PROTECTION PLAN: Travel and medical insurance are available at an additional cost. Information will be sent to you upon registration.

ITINERARY MODIFICATIONS: Itineraries, routing and speakers listed are correct at time of publication and are subject to change.

ENTRY AND VISA REQUIREMENTS: Guests are advised to verify travel documents (passport/transit visa/entry visa) for the country(s) through which they are transiting and/or entering. Reliable and most current information regarding international travel can be found by contacting the consulate/embassy of the country(s) you are visiting or transiting through. We will not be responsible if you are denied entry or transit into a country if you are unable to provide valid documents as per the country's requirement.

RESPONSIBILITY AND OTHER TERMS & CONDITIONS: Certain other provisions concerning, among other things, limitations of Lindblad Expeditions' and National Geographic Expeditions' (a division of National Geographic Partners, LLC) liability for loss of property, injury, illness, or death during the voyage will be provided to all guests on the ship's ticket sent prior to departure or upon request. By registering for a trip, the guest agrees to all such terms and conditions.

CANCELLATION FEE POLICY (PER PERSON)

120 or more days prior to expedition start: No penalty: Advance Payment will be credited toward your next expedition*

119-90 days prior to expedition start: 50% of trip cost***

89-0 days prior to expedition start: 100% of trip cost***

***Advance payments will be credited in the form of a Lindblad Expeditions Travel Certificate, valid for 12 months from the date of cancellation, and which may only be applied towards final payment on any future booking.*

****Trip cost is total price paid including extensions, charter airfare and other additional services.*

We strongly recommend that you purchase a travel protection plan.

Photo Credits: Ralph Lee Hopkins, Michael S. Nolan, Rich Reid, David Vargas, Kyle Furey, Andrew Peacock, Max Seigal, Alberto Montaudon Ferrer, Eric Guth, Marc Cappelletti.

RESERVATION FORM



Alaska's Inside Passage

Aboard *National Geographic Quest*

August 28 – September 4, 2027

To register, please contact:

Flying Longhorns

Ph: 800-594-3900

Online: travel@texasexes.org

Lindblad Expeditions

11 W 42nd St Suite 22 B3

New York, NY 10036

Ph: (833) 985-1261

Fax: (646) 390-2050

Email: groups@expeditions.com

Passenger Information

Please reserve _____ place(s).

Guest 1: _____
(As it appears on I.D.)

Date of Birth: _____ M/F: _____

Email: _____

Primary Phone: _____ Cell Phone: _____

Guest 2: _____
(As it appears on I.D.)

Date of Birth: _____ M/F: _____

Email: _____

Primary Phone: _____ Cell Phone: _____

Street Address: _____

City: _____ State: _____ ZIP: _____

- Accommodations: Double Single Twin share with a friend
 Share with roommate assigned by tour operator.

Please indicate choice of cabin category in order of preference:

1st choice: _____ 2nd choice: _____

Advance Payment Information: 15% of the cabin fare, per person.

If paying by check, please make payable to: **Lindblad Expeditions**

Enclosed is my advance payment of \$ _____

If paying by credit card, we will contact you to finalize your booking and collect payment information.